

## 146-S-54 - SPEEDLINE System Data Sheet - Version V1 (24-10-23)

SPEEDLINE 146mm 'C' Stud Partition @600mm  
Ctrs, with Siniat GTEC 15mm dB Board each side

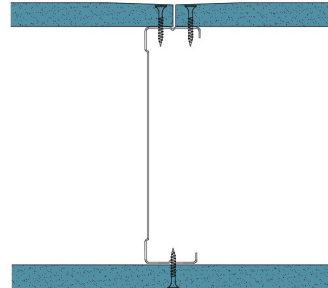

### System Performance Breakdown

Fire Resistance:

BS476 Part 22:1987:

Test Ref & Date or Applied Ref & Report:

Max Height:

Thickness:

Duty Grade: BS 5234: Part 2:1992:

Sound Insulation:

**30/30 Minutes** (Integrity/Insulation).

**BRE 269826 - BRE Report P102396-1011C**

**Refer to Speedline Specification Clause**

**178 mm.** (At Base Track, Excluding Finishes)

**Heavy - Annexes A-F**

**41  $R_w$ dB**, Date Tested or Assessed Against - 70-S-54

Test Code:  
**H17528AA**  
Test Date:  
11/08/2011

Freq. Hz	R dB
50	21.6
63	13.3
80	11.3
100	13.8
125	14.9
160	27.1
200	35.0
250	35.5
315	35.2
400	39.9
500	43.0
630	46.9
800	52.8
1 000	54.4
1 250	55.0
1 600	54.2
2 000	43.6
2 500	39.4
3 150	43.1
4 000	46.4
5 000	50.1
6 300	
8 000	
10 000	

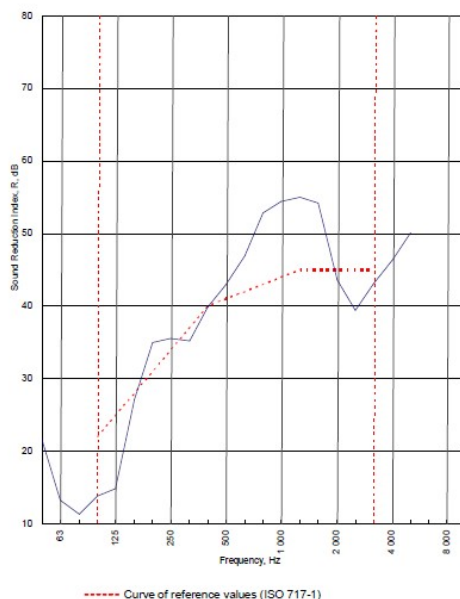

Rating according to BS EN ISO 717-1:1997	<b><math>R_w</math> (C;Ctr) = 41 (-4;-10) dB</b>		
Evaluation based on laboratory measurement results obtained by an engineering method:	$C_{50-150}$ = -5 dB	$C_{50-500}$ = -4 dB	$C_{100-500}$ = -3 dB
	$C_{1,50-150}$ = -13 dB	$C_{1,50-500}$ = -13 dB	$C_{1,100-500}$ = -10 dB

TESTED AT ONE OF THE UKAS ACCREDITED LABORATORIES BELOW

B.T.C  
(H-Ref on Graph)

B.R.E

AIRO

S.R.L

Customer: Metsec plc Hepsec Division



BTC 17528A: Page 8 of 10

SPEEDLINE Drywall Systems, Adsetts House, 16 Europa View, Sheffield Business Park, Sheffield, S9 1XH.

Tel: 0114 231 8030.

Email: [enquiries@speedlinedrywall.co.uk](mailto:enquiries@speedlinedrywall.co.uk)

(As per the requirements set out in ISO/IEC 17025:2017 regarding test data the results stated have been carried out by voestalpine Metsec plc as part of the contract to supply Speedline Metal Sections to SIG Plc)